

classic Bookcase

Sure, it looks great. But that's only part of the story. This project is also versatile, easy-to-build, and solid as a rock.

It only takes a quick look at the photo at left to see that this classic-looking bookcase is a great way to transform some unused wall space into versatile storage. But it's not until you get into all the construction detail that you get the full picture.

ONE SHEET. For starters, the trip to the lumberyard will be easy on the wallet. The case and shelves can all be cut from one sheet of $\frac{3}{4}$ " plywood. Throw in a few board feet of hardwood lumber and a piece of $\frac{1}{4}$ " plywood and you're good to go.

THE BASICS. Once back at the shop, things will go just as easy. This bookcase is built to stand up to about any load, and all it takes to accomplish this is some basic joinery.

The case is built with sturdy, but easy-to-cut, tongue and dado joinery. So you'll have this part of the project together in no time. The face frame is more of the same. Biscuit joinery makes the job quick and easy without sacrificing any strength. Then, when you add some shop-made trim to the case, the bookcase takes on a whole new look.

But, believe it or not, there's one more feature that makes this project even better. And that's how easy it is to expand the bookcase to fill an entire wall, as shown on the following page. All you have to do is build multiple cases, modify the trim a bit, and then fasten them together. So you might say this project is "one design fits all."

CONSTRUCTION DETAILS

OVERALL DIMENSIONS: 33"W x 13½"D x 73¾"H

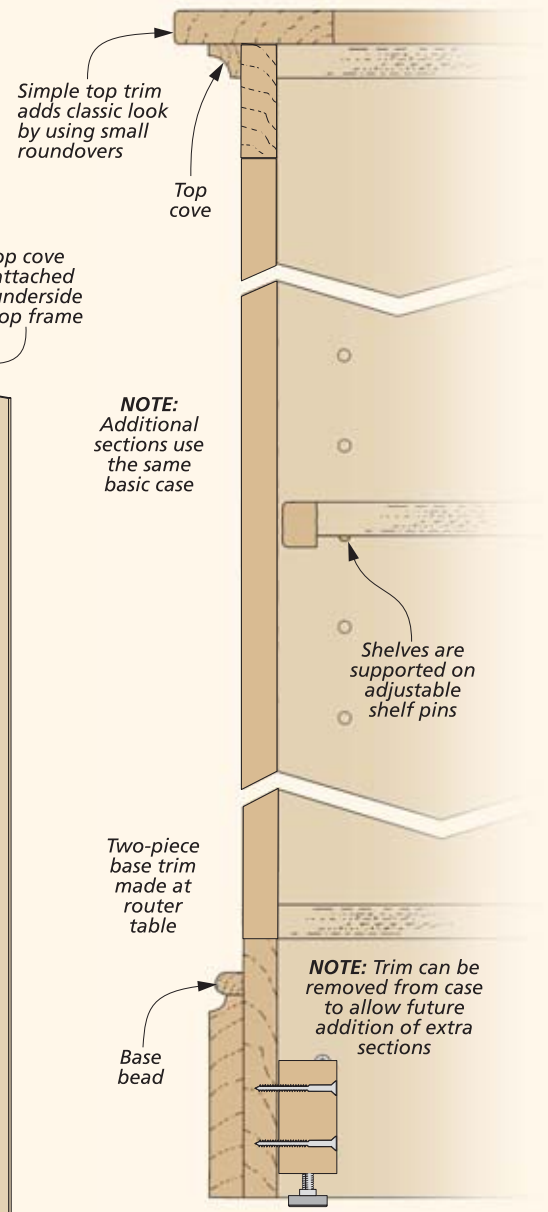
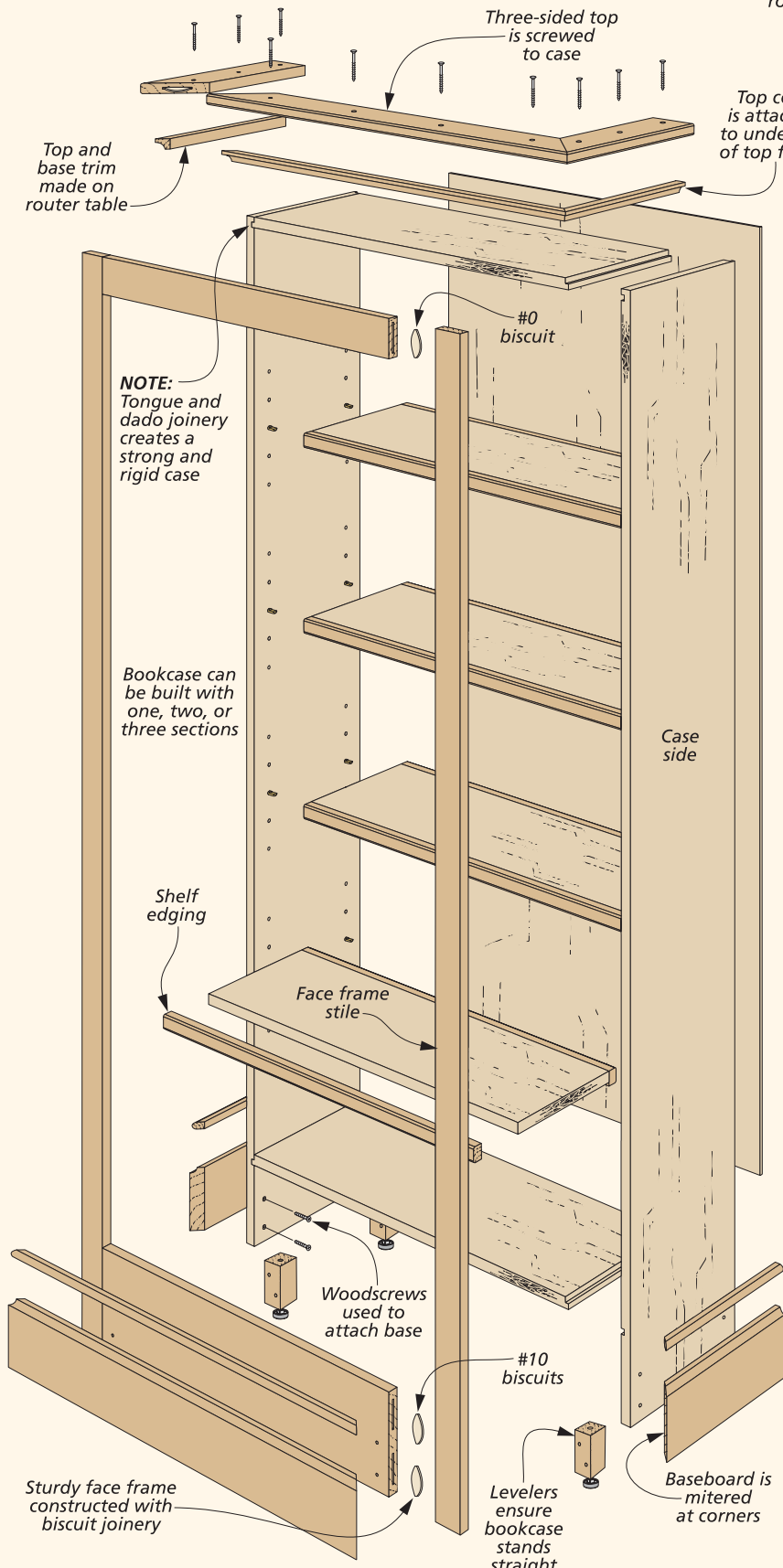

▲ If you like the looks of this project, why not expand it to cover an entire wall? Separately built sections make it easy.